

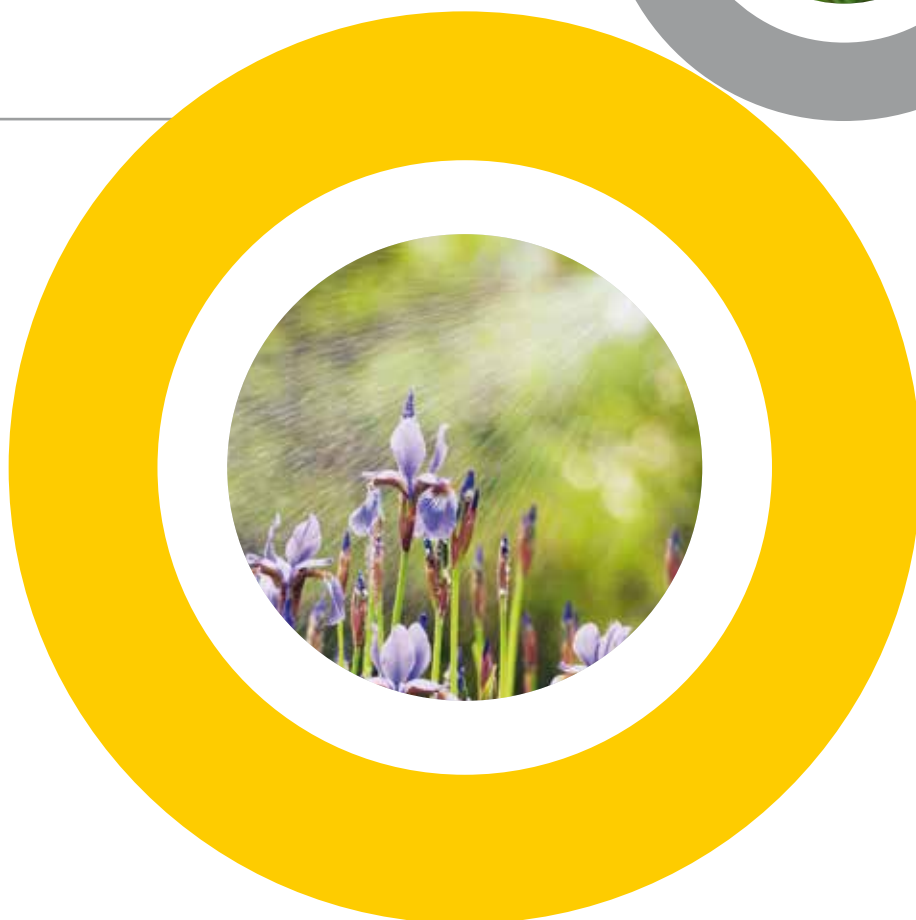

PRODUCT CATALOGUE

[GB]



The best of "Made in Italy" since 1879



Davide & Luigi Volpi Spa manufactures a complete range of **equipment for gardening, nurseries, horticulture and industrial use**: unsurpassed products for reliability, durability, aesthetic value and especially for being very user friendly.

Davide e Luigi Volpi Spa was founded in 1879 for the production of manual knapsack. Over the years the range of products has become more complete adding **compression sprayers, manual and electric dusters, micronizers, powder bellows and electronic knapsack sprayers**.

All phases, from design to testing, are performed inside the company and every operation of the production cycle is followed meticulously in accordance with procedures established and guaranteed by the **Quality Certification ISO 9001:2008**. The continuous improvement in process and technology allowed Volpi to remain a leader of the market attaining high levels of quality and a high degree of reliability of products.

The **Volpi Professional Line**, distinguished by the brand **VOLPI ORIGINALE**, is the best known. This is the most complete line which includes a wide range of articles, both

manual and electric, suitable for the most demanding consumer and for anyone who seeks a professional product for frequent high-performance use and reliable in time.

The **Home & Hobby GREEN FOX Line**, characterised by the four-leaf clover represents another line of products similar to the Volpi Originale line. Can be used for many different applications based upon needs. This line bears the same quality label "produced by Davide e Luigi Volpi S.p.A."

The **VolpiTech Industrial Line** is a special range of products developed in white colour, with special FPM gaskets particularly suitable for chemical solutions. This line of sprayers is used in construction, in the field, for pest control and for cleaning or industrial applications of different types.

With our wide range of products we believe that we are capable of satisfying any request of our present and/or future customer.

Thank you for your kind attention!

VOLPITECH INDUSTRIAL



A RANGE OF SPRAYERS AND PUMP CALLED **VOLPITECH** DESIGNED AND MANUFACTURED TO WITHSTAND CONTACT WITH AGGRESSIVE CHEMICALS . THE COMPONENTS USED IN THESE PUMPS ARE PRODUCED USING MATERIALS SUITABLE FOR CONTACT WITH AGGRESSIVE CHEMICALS AND HAVE SPECIAL FPM GASKETS. THESE PUMPS ARE IDEAL FOR USE IN SECTORS SUCH AS CONSTRUCTION, PEST CONTROL AND TO SPRAY AGGRESSIVE CHEMICALS.





VOLPITECH10 • 10 LITERS

COMPRESSION SPRAYER WITH FPM GASKETS

- TOTAL TANK CAPACITY 10.8 LT
- OPERATING CAPACITY 10 LT
- HD POLYETHYLENE TANK
- PLASTIC PUMP
- PRESSURE 3 BAR
- ADJUSTABLE SHOULDER STRAP AND HANDLE
- SPECIAL FPM GASKETS
- 1.2 M FLEXIBLE HOSE
- LANCE WITH STEERABLE POLYPROPYLENE NOZZLE
- PRESSURE DISCHARGE VALVE
- NET WEIGHT 2.5 KG APPROX.
- ALSO AVAILABLE WITH HOSE WITHOUT LANCE
- ALSO AVAILABLE WITH MANOMETER
- SUITABLE FOR SPRAYING AGGRESSIVE PRODUCTS, PEST CONTROL, INDUSTRIAL APPLICATIONS



PLASTIC PUMP Ø 48

Model	Code	Min. q.ty
10-Liter compression sprayer with FPM gasket and plastic lance	VT10	1
10-Liter compression sprayer with FPM gasket with hose without lance	VT10T	1
10-Liter compression sprayer with FPM gasket, manometer and plastic lance	VT10M	1
10-Liter compression sprayer with FPM gasket, manometer without lance	VT10MT	1
First use spare part kit with FPM gaskets	VT6K	1



Q.ty: **PIECES 1**
Dim.(cm): 22x22x66
Weight (kg): 2,700



Q.ty: **PIECES 40**

spare parts on page 69



PRESSURE DISCHARGE VALVE



MANOMETER ONLY ON MODELS VT10M AND VT10MT



VOLPITECH6 AND VOLPITECH10

INDUSTRIAL SPRAYERS WITH FPM GASKETS

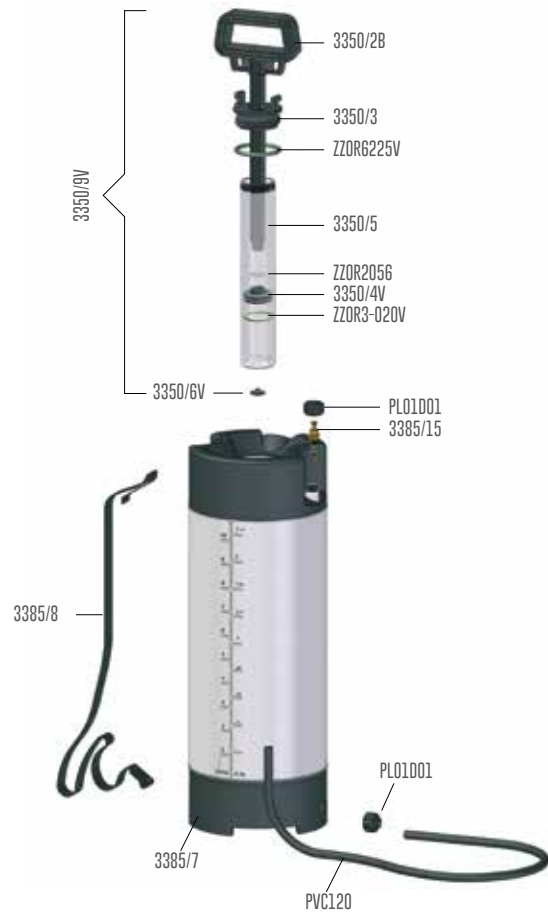
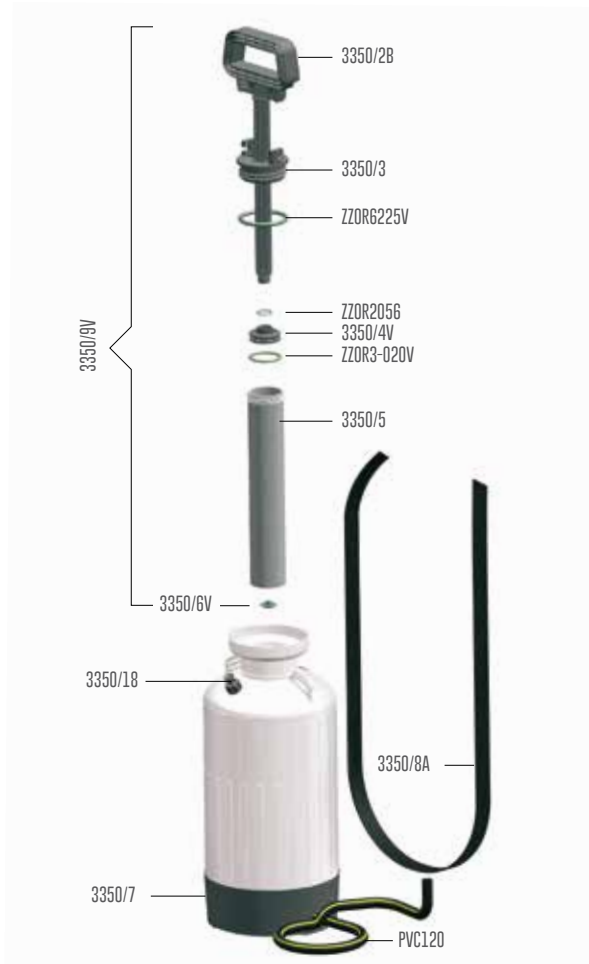

VOLPITECH6

Q.ty	Code	Description
2	3350/2B	Pumping handle for Volpitech6
2	3350/3	Guide cap
2	3350/4V	O-ring Piston for Volpitech6
2	3350/5	Cylinder
2	3350/6V	FPM Bottom valve
2	3350/7	Circular base for Volpitech6
2	3385/8	Shoulder strap with snap hooks
2	3385/7	Circular base for Volpitech10
5	3385/15	Pressure discharge valve for Volpitech10

VOLPITECH10

Q.ty	Code	Description
2	3350/8	Strap with pins for Volpitech6
2	3350/9V	Complete pump for Volpitech6 and Volpitech10 with FPM gaskets
5	3350/18	Pressure discharge valve for Volpitech6
10	ZZOR2056	O-ring to the pumping handle
10	ZZOR3-020V	FPM seal O-ring
10	ZZOR6225V	FPM cover seal O-ring
10	PL01D01	1/2" ring
10	PVC120	Delivery hose